



18TH ANNUAL **DASC**



CHAMPIONSHIP **SHOW**

SPONSORED BY DRESSAGE EXTENSIONS

EL SUENO
EQUESTRIAN CENTER SOMIS, CALIFORNIA

SEPTEMBER 4-6, 2015

USEF USDF DASC AQHA
LEVEL 2 COMPETITION

Dressage Association of Southern California
18th Annual DASC Championship Show

Sponsored by Dressage Extensions

September 4th – 6th, 2015

Entries Close August 24th, 2015

El Sueno Equestrian Center – Somis, CA

Recognized by USEF, USDF, AQHA and DASC
Level 2 Competition

- Judges: Michael Osinski (S), Lacey WA
Sue Malone Casey (S), Highland Village, TX
Cee Cee Moss-Giovanetti (R), Santa Margarita, CA
- Technical Delegate: Jan Welch (R) Lebanon, TN
Show Manager: Victoria Powers (818) 341-2072
Show Secretary: Suzi Kuykendall (818) 269-2911 (suzikdressage@aol.com)
Entry Fax: (805) 386-8286
- Announcer: TBA
Veterinarian: Humphrey, Giacopuzzi (805) 386-4291
Farrier: TBA on site
Medical: Cindy Nish, EMT on site
Food: Delicious food and beverages will be available throughout the show
Photography: Rebecca Neff – www.rebeccaneffphotography.com
Videography: Sally Swart – Kingdom Video (310)541-2299
Stabling: Limited stabling available – see show RULES for details
Shavings: Shavings available for purchase on entry form
Please order *in advance
- Volunteers: Jennifer Nunes (jennunes2360@yahoo.com)
Sponsors/Vendors: Lynn LaCaze - lynn_la_caze@hotmail.com
- Entries: Closing date: August 24th, 2015 – late entries are subject to \$25 late fee.
Send to: El Sueno Equestrian Center, c/o Suzi Kuykendall, 5250
Kingsgrove Road, Somis, CA 93066
Or enter ONLINE at: www.equestrianentries.com

DASC Championships Requirements and Rules

- A. To qualify for DASC Championship classes, a horse/rider combination must obtain at least three (3) qualifying scores from two different judges. Riders may qualify with scores from any test in the level. The qualifying scores are as follows: Introductory Level (AA and JR) – 60%; Training and First Level – 65% for Open and 60% for Adult Amateur and Jr./Young Riders; Second Level – 63% for Open and 59% for AA and Jr/YR; Third, Fourth, Prix St. Georges and Intermediare I – 60% for Open, 57% for AA & Jr/YR. Intermediare II and Grand Prix – 58% for all (Open). Freestyle must obtain one qualifying score of 63%. Riders are asked to verify scores by presenting copies of tests or official USDF or Centerlinescores.com score reports with show entry.
- B. Exceptions to qualifying rule:
- Dressage Equitation** requires one (1) score of 58% or better in a Dressage Equitation Class OR qualification for Championships at any level. Freestyles require one (1) qualifying score of 63% or better or qualification to ride in a Championship Freestyle Class at the respective level.
 - Out of Area** – Members in good standing may obtain qualifying scores from any USEF recognized show provided they reside more than 75 miles from enough DASC recognized shows to qualify. (Example: this year, many San Diego, Riverside, and San Bernardino County members have limited access to DASC recognized shows, and would thus be allowed with this exception) Using this methodology of qualification, it is the responsibility of the member to submit qualifying scores to DASC for approval.
- C. Riders and horses must be paid DASC members to compete in the Championships. They must be members at the time of the qualifying rides. U.S. Citizenship is not required.
- D. At no time during the show may any horse entered in a DASC championship class be ridden by anyone other than the rider entered in that class on the horse except for the groom on a loose rein. Exception: Dressage Equitation – horses entered in Dressage Equitation are exempt from this rule for that class *only*.
- E. A horse may not enter two divisions (e.g. Open and Amateur) in the same level.
- F. Non-Championship classes are open to all. There are no DASC membership, score, or citizenship limitations. Non-member fees will apply where applicable. Ribbons awarded to fifth place.
- G. Qualifying scores earned in open classes at the 2015 Championship show will count toward DASC 2016 Championship show qualification. Scores in the Championship classes will not.
- H. All ties will be broken via the General Impressions section of the score sheets (per USEF rule DR123.3)
- I. Championship classes take precedence over non-championship classes if show is over-subscribed. Entries will

be taken on a first-come, first-served basis for all levels offered.

- J. No whips may be carried in championship classes, and the test may not be called.

General Rules and Information

1. RULES: This show is covered by the rules and specifications of the current USEF Rule Book and will be conducted and judged in accordance therewith.

2. ENTRIES: Entries close and must be postmarked by no later than August 24th, 2015. The final date to qualify for Championship Classes is August 24th, 2015. All entries must submit copies of their USEF, USDF and DASC cards for rider, owner and the horse, as well as a printout of qualifying scores from USDF or centerlinescores.com. It is the competitors responsibility to verify eligibility via score submission *with* entry. We encourage all entrants to use www.eqverification.org to print USEF/USDF cards for horse/rider/owner and the DASC website (www.socaldressage.com) to print DASC cards for horse/rider/owner. We recommend www.usdf.org/usdfscores to print out verification of scores. If entries are missing cards prior to the closing date, a fee of \$5 per card up to \$20 may be charged to the entry so that the secretary can print the cards prior to the show. Entries accepted on a first-come, first-serve basis. No numbers will be issued without complete entries, full payment, signatures, fees and association numbers. Parents or guardians must sign entry blanks of minors.

LATE ENTRIES: Entries postmarked after the closing date will be subject to a late fee of \$25.

INCOMPLETE ENTRIES: Subject to a \$20 fee.

CHANGES: All entry changes made after the closing date, at the request of the competitor, will be subject to a fee of \$25.

SCRATCHES: Scratches made **prior to the closing date** will be refunded. It is the exhibitors responsibility to inform the show manager, or Suzi Kuykendall, Show Secretary of their intention to scratch. To scratch, email suzikdressage@aol.com or fax to (805) 386-8286. **It must be in writing.** There will be NO REFUNDS or CREDITS after the closing date. In the event of horse illness or injury after August 24th, **only** class fees may be refunded **with a Veterinarian Certificate**. No refunds of any fees for scratches made after the show starts.

POST ENTRIES: Post entries will be accepted to fill scratches if the schedule permits. Horses already entered in the show will receive priority.

RETURNED CHECKS: All checks returned by the bank will be charged an additional 10% penalty (\$25 minimum). Accounts will be given 10 days to be paid in full with cash or equivalent or they will be turned over to the USEF for further disciplinary action.

3. ELIGIBILITY: Life, senior active and junior active members shall be eligible to participate in all classes at regular competitions, eventing competitions at the preliminary level or above and combined driving competitions at the advanced level, dressage, reining and vaulting competitions and endurance rides provided the respective breed/discipline category fee has been paid. A non-member may participate as a handler, rider, driver, owner, lessee, agent, coach or trainer at regular competitions, eventing competitions, dressage competitions, reining competitions and combined driving competitions upon payment of a \$30 non-member registration fee. Participants in the following classes are exempted from the requirements of this rule; 1) leadline; 2) exhibitions; 3) games and races; 4) classes for 4-H members; 5) walk/trot and academy classes (Academy classes are classes limited to horses used regularly in a lesson program); 6) USDF introductory level tests, pas de deux and quadrille classes; 7) NrHA endorsed reining competitions, 8) opportunity classes, 9) citizens of other nations who have proof, in English, of current membership in good standing of their own national federation; 10) USEA beginner

novice division; and 11) assistant handlers in dressage sport horse breeding classes. (See Gr807.4 of the Federation rules.)

4. MEMBERSHIP FEES: USEF Admin. Fee \$16. CDFA drug fee \$5. USEF non-member fee \$30. USDF non-member fee \$25. DASC Championship Show Fee \$3. These fees apply per show. Only horses entered into GAIG/USDF qualifying classes are required to have a USEF horse number. Copies of current membership cards MUST accompany entry form. If current card copies are not included a \$10 per association fee for on-line verification will be charged.

5. MINOR EXHIBITORS: Parents or guardians of minor exhibitors shall hold Competition harmless for injury to such minor. No minor's entry will be accepted unless it is signed by a parent or guardian. The signatures of instructors, agents or other unrelated persons will not be acceptable.

6. CONDITIONS OF ENTRY: Every horse entered for competition will be under the control of the Horse Show Management, but the Horse Show Management will, in no case, be responsible for any loss or damage that may occur, and it shall be a condition of entry that each exhibitor shall hold the Dressage Association of Southern California (DASC), El Sueno Equestrian Center, its Directors and Employees, harmless for any loss or accident to his horse, horses or equipment which may occur from accident, sickness, fire or otherwise. Management reserves the right to cancel, combine or divide classes, or to change officials as it deems necessary. The decision of Show Management is final.

7. MANAGEMENT: Show Management reserves the right to interpret all questions and conditions in regard to or arising out of any incident in the show without claims for damages or recourse of any kind. All questions not covered in these rules and regulations shall be decided by Show Management and their decision will be final. Show Management reserves itself the right to refuse, accept conditionally, or to cancel any entries disqualify riders or exhibitors, prohibit exhibition of entries and to cancel award prizes, without claim to damage, to change, cancel or combine any classes, to reschedule classes after due notice to exhibitors, or to change rings or substitute officials. The judges decisions are strictly their own and Management accepts absolutely no responsibility for those decisions.

8. ARENAS. Eurofelt/sand footing is used in the 20x60 M covered competition arena. Outdoor Nike Lightfoot/sand is used in the 20x60 M Outdoor competition arena. Outdoor Nike Airfoot/sand is used in the warm-up arena. Only horses entered in the show are permitted to use the warm-up arenas and the competition arenas. No one on foot will be permitted in the warmup arenas. Lunging is to be done in designated areas ONLY. All arenas must be vacated when equipment is in use. Use of the warm-up arena is limited to those who are entered in the show and, at the discretion of the Show Management, will be restricted to those warming up for class(es) in progress when there is congestion. Horses are not to be left unattended in arenas at any time. No one may ride a horse entered in the competition on the competition grounds who has not signed an entry form.

9. CLOSED ARENAS: Horses are not permitted in competition arenas on a show day at any time other than scheduled riding times. Violation may be cause for elimination.

10. LUNGEING: Absolutely no lunging in the warm-up arenas. Lunging in designated areas only.

11. RIDING TIMES: Ride times will not be mailed – Tentative times will be posted at www.socaldressage.com and/or www.dressagetimes.com. It is the rider's responsibility to inform the management of any time conflicts at least 72 hours prior to the scheduled rides. It is also the rider's responsibility to check the ride times at the horse show office at the start of each day to identify any pertinent schedule changes. Failure to enter the ring by the specified time will result in elimination from the class. Classes will be scheduled to accommodate the judges, riders and management. The 50 minutes between rides rule will be observed for riders of multiple horses. Classes will not necessarily be scheduled in order of difficulty and regular classes may or may not occur before

championship classes of the same level. It is the responsibility of the rider to inform management of any time conflicts at least 24 hours before the scheduled rides.

It is the riders responsibility to check the revised schedule which will be posted every evening at the show office.

12. TESTS: Current USEF and FEI Tests will be ridden. Current Olympic GP Special Tests will be used. FEI and USDF Musical Freestyles are offered.

13. 2016 GREAT AMERICAN/USDF QUALIFYING REQUIREMENTS: In order to qualify for a Regional Championship, horse/rider combinations may qualify by earning a minimum of two qualifying scores at two official GREAT AMERICAN/USDF recognized competitions from two different judges in any region. Riders may now ride in Qualifying classes both days. Go to www.usdf.org to find the minimum qualifying scores required for each level. Non US Citizens may ride in Qualifying classes.

14.SCORED TEST: Tests will be given ONLY TO RIDERS or their agents and only after the class is placed. Check all scores upon receipt of test. Any discrepancies must be reported immediately.

15.RIBBONS AND AWARDS: Ribbons will be awarded to sixth place in regular dressage classes. Prizes/neck ribbons will be awarded to the Champion and neck ribbons will be awarded through sixth place in Championship Classes.

16.STABLING: Very limited stabling is available onsite. Stabling requests will be accepted on a first come-first served basis, with priority given to long distance competitors. Stabling is available from Thursday-Sunday at weekend rates: A limited number of larger (Premium) stalls are available at \$225. Regular show stabling is available \$175, and Due to the demand for stalls and limited availability, tack stalls will likely not be available. If they do become available, they will also be on a first-entered, first assigned basis. Fees include first bedding. Competitors are responsible for their own feed and additional bedding, as well as cleaning their own stalls. You may bring your own shavings or shavings may be purchased at El Sueno for \$10 per bale. Please call 818 269-2911 or email suzikdressage@aol.com BEFORE September 2nd. to order. Exhibitor must pay feed and shavings bills before leaving the show grounds. Any exhibitor leaving the grounds with an unpaid balance will be billed these charges plus a \$25 billing fee will be added to the total. Non-locking snaps or clips are suggested for horse stalls. Regular stalls do not have automatic water – be sure to bring water buckets and a hose. DASC is not responsible for lost or stolen items from the barn area – plan accordingly and lock your valuables away. Manure must be deposited in designated areas only. Day stall requests are accepted once all weekend requests have been fulfilled.

Owner/Agent/Participant assumes all care, custody and control with regard to this use. A Grounds Fee of \$40 per day will be in effect for horses that are not stabling.

17.PARKING: Parking of cars, truck and trailers is allowed in designated areas ONLY! Please be respectful of the derby field and other competitors in the trailer-in areas. No overnight parking allowed.

18.FOOD: Food will be available on the grounds.

19.DOGS: ALL DOGS MUST BE ON A LEASH AT ALL TIMES AND OWNERS MAY BE ASKED TO PROVIDE PROOF OF CURRENT RABIES VACCINATION. Owners are expected to clean up after their dogs.

20.CANCELLATION: In the event of rain prior to the show, it is the competitor's responsibility to call the show management to determine whether the show is canceled. Shows are NOT canceled unless footing is deemed unsafe. If the show is canceled for any reason a \$20 per day office fee will be retained from each entry and the balance refunded. Call (818) 242-6247 (show office) for competition status.

21. MINORS : Parents or guardians of Minor Exhibitors shall hold El Sueno Equestrian harmless for injury to such minor. No Child's entry blank shall be accepted unless it is signed by a parent or guardian. The signature of instructors, agents or other unrelated persons will not be accepted. Minors who do not have a valid driver's license which allows

them to operate a motorized vehicle in the state in which they reside will not be permitted to operate a motorized vehicle of any kind, including, but not limited to, golf carts, motorcycles, scooters, or farm utility vehicles, on the competition grounds. Minors who have a valid temporary license may operate the above described vehicles if they are accompanied by an adult with a valid driver's license. Violations of this rule will be cause for sanctions against the parent(s), guardian(s) and/or trainer(s) who are responsible for minor. Penalties may include exclusion of the child, parent(s), guardian(s), and/or trainer(s) from the competition grounds for the remainder of the competition and charges being filed against the above individuals. Wheelchairs and mobility assistance devices for individuals with disabilities are exempt from this rule.

22. SCHOOLING HORSES: Horses may enter the show for schooling on show grounds. Please complete the entry form and send association information. Schooling fee \$45 per show plus grounds fees. There is no stabling available for schooling horses.

23. RV PARKING: RV hookups **are not** available. Overnight parking is **not** permitted.

24. BRIDLE NUMBERS: Bridle numbers must be worn at times when the horse is out of the stall.

25. DO NOT WASH HORSES IN BARN AREA. PLEASE USE THE DESIGNATED WASH RACKS

26. SHARPS CONTAINERS: Competition management is responsible for placing Sharps containers in convenient locations on Competition grounds and replacing them when full. Competition Management may fine any individual up to \$100 for improper disposal of needles or other sharp disposable instruments. Competition management will place notice of this requirement either in its prize list or on a specific handout given to trainers on check in at the competition. See GR1210.4 for complete details and please make sure the requirements for Sharps Containers are met at this competition.

27. FREESTYLES: In order to enter a freestyle class at any level, as horse/rider combination must have received a minimum score of 60% or higher in the highest test of the freestyle level or any test of a higher level. A photocopy of the test verifying eligibility must be submitted with the Freestyle Class entry. It is the responsibility of the exhibitor to have the cued music to the announcer or show office before the start of the show. A sound check will be scheduled before the ride, please make arrangements at check-in. Exhibitors are responsible for retrieving their music after the class. Sound system will be provided by El Sueno Equestrian Center – competitor is responsible for having freestyle music available in either CD or MP3 format (a backup CD is HIGHLY recommended), and present it to the announcer or horse show office at the start of the show day.

29. HELMETS: Effective April 1, 2013 for dressage: Anyone mounted on a horse must wear protective headgear.

AWARDS ~ RIBBONS ~ TROPHIES ~ MEDALS

- Neck sash ribbons to sixth place in championship classes. Ribbons to sixth in non-championship classes. Prizes and rider sashes to Champions in all Championship classes.
- High Point award/High Point Reserve awarded each day.
- **Open High Score Award** – awarded to highest scoring Open rider in a Championship class.
- **Adult Amateur High Score Award** – awarded to the highest scoring AA rider in a Championship Class
- **Rising Star Award** – awarded to the highest scoring Junior/Young Rider in a Championship class

- **Kingdom Video Award** – awarded to the highest scoring Adult Amateur FEI horse/rider in a Championship Class.
- **Special Awards** – offered in a variety of categories: Best Barn Snacks, Best Braids, Craziest Boot Socks, Best Barn Spirit, Most Green Spots on a Grey Horse and others. Nominate your horse/barn/friends at the Horse Show Office ***at check in*** to be considered for these awards.

USDF/Dover Saddlery Medal Program

USDF/Dover Saddlery Medal Recipient

The eligible rider with the highest score of 60 percent or better in the designated Second Level Test Three class or applicable test of choice USDF/Dover Saddlery Adult Amateur Medal class at a participating competition will receive a handcrafted USDF/Dover Saddlery pewter medal and neck ribbon. Winners will receive a \$20 Dover Saddlery gift certificate for the first three USDF/Dover Saddlery Medals they win during the competition season.

USDF/Dover Saddlery National Merit Award

A USDF/Dover Saddlery National Merit Award will be awarded to riders winning three USDF/Dover Saddlery Medals in the same competition year.

Year-End Awards

The USDF/Dover Saddlery Medal National Champion and Reserve Champion are determined from the average of the top three winning ride scores during the competition year. The champion receives a \$1000 Dover Saddlery gift certificate and the reserve champion receives a \$500 Dover Saddlery gift certificate.

RIDER ELIGIBILITY

Rider must have current USDF Participating or Group Membership and be a member of good standing of USDF when the scores are earned.

Rider must be an adult amateur in accordance with Article GR1306 of the USEF rules and be designated with USEF as an adult amateur at the time the scores are earned.

OWNER & HORSE ELIGIBILITY

Horse and owner must meet minimum competition requirements at the time the scores are earned.

For additional information: an updated list of competitions offering the USDF/Dover Saddlery Adult Amateur Medal Program, visit www.usdf.org/awards/performance/adultmedalprogram.asp.

Volunteers!

We Need YOU!!

The success of the Championship show really depends on the help of volunteers like you. Whether you can give a couple of hours or the whole weekend, please share your energy with us and be part of a great event!

Special gifts and Volunteer Incentive Credits will be offered at the Championship Show - they ARE transferrable, so even non-members can earn credits for you too!

(full details on the Volunteer Incentive program are on the DASC Website)

VOLUNTEERS

This show would NOT be possible without the help of our generous volunteers. Please consider giving some time and energy to help make this the best show it can be!! (no experience necessary!)

All volunteers will receive free food and drinks, gift bags and our unending gratitude and appreciation! Also, volunteers receive *double* VIP points for working at the Championship Show! (see the DASC website for info on our VIP program) Don't worry if you've never done it before - we're happy to show you the ropes!

We're using VolunteerSpot (the leading online signup and reminder tool) to organize our volunteers at the show.

Please sign up for DASC Championship Show - here's how it works in 3 easy steps:

1. Use this link to go to our invitation page on VolunteerSpot: <http://vols.pt/Fytas2>
2. Enter your email address: (You will NOT need to register an account on VolunteerSpot)
3. Sign up! Choose your spots - VolunteerSpot will send you an automated confirmation and reminders. Easy!

Note: VolunteerSpot does not share your email address with anyone. If you prefer not to use your email address, please contact the office and we can sign you up manually. (e-mail us at office@socaldressage.com)

DASC MEMBERS! Be sure to RSVP to our very special Members Only event! See below for details:

DASC
DRESSAGE ASSOCIATION OF
SOUTHERN CALIFORNIA

Join us for a special evening of friends,
dressage and shopping!

"DASC Celebrates Dressage"
sponsored by Dressage Extensions for

**DASC
MEMBERS
ONLY***

**AFTER HOURS
SHOPPING EXPERIENCE**

WINE AND CHEESE PARTY

**DOOR PRIZES
SAMPLE SALES
HUGE DISCOUNTS
SUPER SPECIALS
SECRET PRIZE!!!**

Don't miss out on this special event!!!
Shop for your DASC Championship Show needs!

Meet the DASC Board of Directors and
share your ideas for the future of DASC

**Master Class with Rebecca Nunes,
Purina Nutritionist**

**Thursday, September 3rd
6:00pm to 8:00pm**

Free of charge.

***DASC member friends
and family invited.**

RVSP to: dasc@dressageextensions.com
no later than August 24, 2015.

**Dressage
Extensions**

**Dressage Extensions Store
11943 Discovery Court
Moorpark, CA 93021**



VOLUNTEER AT THE CHAMPIONSHIP SHOW AND GET DOUBLE CREDIT!

SEPTEMBER 4-6, 2015

EL SUENO EQUESTRIAN CENTER

We can't do this without help from great volunteers, so sign up to volunteer and earn DOUBLE credits for your efforts. Additionally, all volunteers will be entered in a drawing each day (1 ticket for each hour) for some great prizes.

Full and half day volunteers get lunch, hats, goodie bags and other surprises – plus, it's fun!

We need:

Scribes	Gatekeepers
Scorers	Runners
Ring Stewards	Hospitality Helpers
Equipment Checks	Silent Auction Helpers
Set Up – before show (Thursday afternoon)	
Tear Down – after show (Sunday afternoon)	

To sign up or get more information, drop us a note at: office@socaldressage.com
Sign up early to get your first choice of jobs!

**DON'T
FORGET
TO
RSVP
FOR
THIS
EVENT!**



**Join us for a special evening of friends,
dressage and shopping!**

**"DASC Celebrates Dressage"
sponsored by Dressage Extensions for**

**DASC
MEMBERS
ONLY***

**AFTER HOURS
SHOPPING EXPERIENCE**

WINE AND CHEESE PARTY

**DOOR PRIZES
SAMPLE SALES
HUGE DISCOUNTS
SUPER SPECIALS
SECRET PRIZE!!!**

**Don't miss out on this special event!!!
Shop for your DASC Championship Show needs!**

**Meet the DASC Board of Directors and
share your ideas for the future of DASC**

**Master Class with Rebecca Nunes,
Parina Nutritionist**

**Thursday, September 3rd
6:00pm to 8:00pm**

Free of charge.

***DASC member friends
and family invited.**

**RVSP to: dasc@dressageextensions.com
no later than August 24, 2015.**



**Dressage Extensions Store
11943 Discovery Court
Moorpark, CA 93021**

e-mail:
[dasc@
dressageextensions.com](mailto:dasc@dressageextensions.com)

DASC Championship Show - Class Schedule

Fri	Sat	Sun	Class Name	Section
1			Dressage Equitation	A-J
	2		Dressage Equitation Championship	JR
	3		Dressage Equitation Championship	AD/AM
20	21		USDF Introductory Test A	O-A-J
22	23		USDF Introductory Test B	O-A-J
24	25		USDF Introductory Test C	O-A-J
	26		USDF Introductory Championship Test C	AD/AM
	27		USDF Introductory Championship Test C	JR/YR
101	201	301	Training Level Test 1	O-A-J
102	202	302	Training Level Test 2	O-A-J
103	203	303	Training Level Test 3	O-A-J-Q
		401	Training Level Test 3 DASC Championship	OPEN
		402	Training Level Test 3 DASC Championship	AD/AM
		403	Training Level Test 3 DASC Championship	JR/YR
111	211	311	First Level Test 1	O-A-J
112	212	312	First Level Test 2	O-A-J
113	213	313	First Level Test 3	O-A-J-Q
	411		First Level Test 3 DASC Championship	OPEN
	412		First Level Test 3 DASC Championship	AD/AM
	413		First Level Test 3 DASC Championship	JR/YR
121	221	321	Second Level Test 1	O-A-J
122	222	322	Second Level Test 2	O-A-J
123		323	Second Level Test 3	O-A-J-Q
	223		Second Level Test 3 USDF/Dover Saddlery Medal	A
		421	Second Level Test 3 DASC Championship	OPEN
		422	Second Level Test 3 DASC Championship	AD/AM
		423	Second Level Test 3 DASC Championship	JR/YR
131	231	331	Third Level Test 1	O-A-J
133	232	332	Third Level Test 2	O-A-J
133	233	333	Third Level Test 3	O-A-J-Q
	431		Third Level Test 3 DASC Championship	OPEN
	432		Third Level Test 3 DASC Championship	AD/AM
	433		Third Level Test 3 DASC Championship	JR/YR
141	241	341	Fourth Level Test 1	O-A-J-Q
142	242	342	Fourth Level Test 2	O-A-J-Q
143	243	343	Fourth Level Test 3	O-A-J-Q
		441	Fourth Level Test 3 DASC Championship	OPEN
		442	Fourth Level Test 3 DASC Championship	AD/AM
		443	Fourth Level Test 3 DASC Championship	JR/YR
150	250	350	Prix St. Georges	O-A-J-Q
	450		Prix St. Georges DASC Championship	OPEN
	451		Prix St. Georges DASC Championship	AD/AM
	452		Prix St. Georges DASC Championship	JR/YR
160	260	360	Intermediare I	O-A-J-Q
		460	Intermediare I DASC Championship	OPEN
		461	Intermediare I DASC Championship	AD/AM
		462	Intermediare I DASC Championship	JR/YR
170	270	370	Intermediare II	O-A-J-Q
	470		Intermediare II DASC Championship	OPEN

Fri	Sat	Sun	Class Name	Section
180	280	380	Grand Prix	O-A-J-Q
		480	Grand Prix DASC Championship	OPEN
190	290	390	USDF Freestyle Test of Choice (1st-4th)	OPEN - Q
195	295	395	Intermediare Freestyle	OPEN - Q
196	296	396	Grand Prix Freestyle	OPEN - Q
	480		Training Level Freestyle DASC Championship	OPEN
	481		Training Level Freestyle DASC Championship	AA/JR
		482	First Level Freestyle DASC Championship	OPEN
		483	First Level Freestyle DASC Championship	AA/JR
	484		Second Level Freestyle DASC Championship	OPEN
	485		Second Level Freestyle DASC Championship	AA/JR
		486	Third Level Freestyle DASC Championship	OPEN
		497	Third Level Freestyle DASC Championship	AA/JR
	488		Fourth Level Freestyle DASC Championship	OPEN
	489		Fourth Level Freestyle DASC Championship	AA/JR
	490		Intermediare Freestyle DASC Championship	OPEN
	491		Intermediare Freestyle DASC Championship	AA/JR
	492		Grand Prix Freestyle DASC Championship	OPEN
	493		Grand Prix Freestyle DASC Championship	AA/JR
	300		Leadline Class	
	400		TOC Special Exhibition (Quadrille, Pas de Deux)	

Entry Fees:

Championship Classes:	\$85 per test
Non Championship Classes	\$50 per test
Non Championship FEI Classes	\$65 per test
Equitation Classes (regular)	\$25 per test
Equitation Championship Classes	\$35 per test
Great Am/USDF Qualification (optional)	\$10 per test
Exhibition Classes 300 & 400	No charge

Q = Great American/USDF Qualifying Class for Regional Championships for 2016.

All classes count towards year end awards for USDF, USEF and DASC for 2015.

Non Championship classes are qualifiers for the 2016 DASC Championship Show.

VOLUNTEERS!!

We need your help!! Even if just for a short time, or all day - we are offering fun incentives & good times at this great event - no experience necessary!! See show premium or drop a note to office@socaldressage.com for more info and to sign up! Get DOUBLE VIP points for volunteering at the show!!

18th Annual DASC Championship Show

Sponsored by: Dressage Extensions

Dressage Level 2 USEF – USDF – AQHA – DASC recognized

September 4th – 6th, 2015

Entries must be postmarked by Aug. 24th

Mail entries to: El Sueno c/o Suzi Kuykendall

5250 Kingsgrove Rd., Somis CA 93066

Make all checks payable to: DASC

Note: ONE horse & rider per entry form - please type or print clearly

Print your USEF/USDF cards at www.eqverification.com Print your DASC card at

www.socaldressage.com.

Print your score report at USDF or centerlinescores.com

Entries without copies of cards and score reports are subject to additional office fees.

**** You can also submit your entry online using www.equestrianentries.com****

Indicate class number, division (and Q if paying \$10 for USDF qualification)						
	Class #	Division	Class #	Division	Class #	Division
Friday		O AA		O AA		O AA
		JR Q		JR Q		JR Q
Saturday		O AA		O AA		O AA
		JR Q		JR Q		JR Q
Sunday		O AA		O AA		O AA
		JR Q		JR Q		JR Q

Owner Information	
Name:	
Address:	
City:	
State, Zip:	
Phone:	
Fax:	
e-mail:	
USEF #:	USDF#:
DASC#:	

Trainer Information	
Name:	
Address:	
City:	
State, Zip:	
Phone:	
Fax:	
e-mail:	
USEF #:	USDF#:
DASC#:	

Coach Information	
Name:	
Address:	
City:	
State, Zip:	
Phone:	
Fax:	
e-mail:	
USEF #:	USDF#:
DASC#:	

Rider Information	
Name:	
Address:	
City:	
State, Zip:	
Phone:	
Fax:	
e-mail:	
USEF #:	USDF#:
DASC#:	

Horse Information	
Name:	
Breed:	
Height:	
Color:	
Sex: M G S (circle one)	
Age:	
USEF#:	USDF#
DASC#	

Total Class Fees: (add \$10 for each USDF Q class)		
Mandatory CDFA Drug Fee (required)		\$5.00
USEF Drugs & Medication Fee (required)		\$16.00
DASC Championship Show Fee (required)		\$3.00
DASC Administration Fee (required)		\$25.00
Grounds Fee (per day, for trailer ins)	\$40.00	
Late Fee (postmarked after 8/24)	\$25.00	
USDF Non-member Fee	\$25.00	
USEF Non-member Fee	\$30.00	
Stall Fees:		
Shavings: \$10/bag x #of bags _____		
Championship Class Sponsorship	\$150.00	
TOTAL FEES:		
Check#:		
Credit cards only accepted when using the equestrianentries.com service		

Stabling Information and Reservation

Onsite stabling is available but is limited. Assignments are on a first-come, first-served basis, with priority to long distance entries. Due to limited number of stalls, tack stalls may not be available. See STABLING section of the rules for more information. **Day stalls may be assigned after all weekend requests are filled. Shavings are available for purchase – see RULES for details

Weekend: (thurs-sun) \$175**
 Premium Weekend \$225
 Day stalls (if available) \$75

Number of stalls required: _____ Arrival date: _____ Departure Date: _____
 Stable with: _____

For office use only:

FEDERATION ENTRY AGREEMENT

By entering a Federation-licensed Competition and signing this entry blank as the Owner, Lessee, Trainer, Manager, Agent, Coach, Driver, Rider, Handler, Vaulteur or Longeur and on behalf of myself and my principals, representatives, employees and agents, I agree that I am subject to the Bylaws and Rules of The United States Equestrian Federation, Inc. (the "Federation") and the local rules of DASC Championship Show (Competition). I agree to be bound by the Bylaws and Rules of the Federation and of the competition. I will accept as final the decision of the Hearing Committee on any question arising under the Rules, and agree to release and hold harmless the competition, the Federation, their officials, directors and employees for any action taken under the Rules. I represent that I am eligible to enter and/or participate under the Rules, and every horse I am entering is eligible as entered. I also agree that as a condition of and in consideration of acceptance of entry, the Federation and/or the Competition may use or assign photographs, videos, audios, cable - casts, broadcasts, internet, film, new media or other likenesses of me and my horse taken during the course of the competition for the promotion, coverage or benefit of the competition, sport, or the Federation. Those likenesses shall not be used to advertise a product and they may not be used in such a way as to jeopardize amateur status. I hereby expressly and irrevocably waive and release any rights in connection with such use, including any claim to compensation, invasion of privacy, right of publicity, or to misappropriation. The construction and application of Federation rules are governed by the laws of the State of New York, and any action instituted against the Federation must be filed in New York State. See GR908.4.

Federation Release, Assumption of Risk, Waiver, and Indemnification

This document waives important legal rights. Read it carefully before signing.

- I **AGREE** in consideration for my participation in this Competition to the following:
- I **AGREE** that the "Federation" and "Competition" as used herein includes the Licensee and Competition Management, as well as all of their officials, officers, directors, employees, agents, personnel, volunteers and Federation affiliates.
- I **AGREE** that I choose to participate voluntarily in the Competition with my horse, as a rider, driver, handler, vaulteur, longeur, lessee, owner, agent, coach, trainer, or as parent or guardian of a junior exhibitor. I am fully aware and acknowledge that horse sports and the Competition involve inherent dangerous risks of accident, loss, and serious bodily injury including broken bones, head injuries, trauma, pain, suffering, or death. ("Harm").
- I **AGREE** to hold harmless and release the Federation and the Competition from all claims for money damages or otherwise for any Harm to me or my horse and for any Harm of any nature caused by me or my horse to others, even if the Harm arises or results, directly or indirectly, from the negligence of the Federation or the Competition.
- I **AGREE** to expressly assume all risks of Harm to me or my horse, including Harm resulting from the negligence of the Federation or the Competition.
- I **AGREE** to indemnify (that is, to pay any losses, damages, or costs incurred by) the Federation and the Competition and to hold them harmless with respect to claims for Harm to me or my horse, and for claims made by others for any Harm caused by me or my horse while at the Competition. I have read the Federation Rules about protective equipment, including GR801 and, if applicable, EV114, and I understand that I am entitled to wear protective equipment without penalty, and I acknowledge that the Federation strongly encourages me to do so while WARNING that no protective equipment can guard against all injuries. If I am a parent or guardian of a junior exhibitor, I consent to the child's participation and AGREE to all of the above provisions and AGREE to assume all of the obligations of this Release on the child's behalf I represent that I have the requisite training, coaching and abilities to safely compete in this competition.
- I **AGREE** that if I am injured at this competition, the medical personnel treating my injuries may provide information on my injury and treatment to the Federation on the official USEF accident/injury report form.

BY SIGNING BELOW, I AGREE to be bound by all applicable Federation Rules and all terms and provisions of this entry blank **and all terms and provisions of this Prize List. If I am signing and submitting this Agreement electronically, I acknowledge that my electronic signature shall have the same validity, force and effect as if I affixed my signature by my own hand. BOD 1/23/11 Effective 12/1/11**

RIDER/DRIVER/HANDLER/ Vaulteur/Longeur (mandatory) Signature: _____ Print Name: _____	OWNER/AGENT (mandatory) Signature: _____ Print Name: _____	TRAINER (mandatory) Signature: _____ Print Name: _____	COACH (if applicable) Signature: _____ Print Name: _____
Parent/Guardian Signature: (Required if Rider/Driver/Handler/Vaulteur/Longeur is a minor) _____			
Print Parent//Guardian Name: _____		Emergency Contact Phone No. _____	
Is Rider/Driver/Vaulteur a U.S. Citizen: <input type="checkbox"/> Yes <input type="checkbox"/> No			

SPECIAL AWARDS!!!

Each year, the show committee bestows special recognition to competitors in a variety of unique categories. All weekend, nominations will be accepted and photos taken at the show office.

Winners will be announced at noon on Sunday and posted at office.

THIS YEAR'S CATEGORIES ARE:

BEST BRAIDS

(do the "do"!)

CRAZIEST BOOT SOCKS

(get crazy!!)

BEST BARN SNACKS

(to eat well, is to live well)

BARN SPIRIT AWARD

(It takes a village...)

BEST BLING

(adding pizzazz to the same old jazz!)

GOOD MORNING!!!

Join us each morning at the show office for a little breakfast, with good luck wishes from your DASC Show committee!

fresh fruit

tea

coffee



breakfast breads

hot cocoa

Riders!
Trainers!
Families!

Consider placing an ad in the DASC Championship Program that

CONGRATULATES

your students, family members or friends for all their hard work this show season!!

Thank your trainer and supporters!
Honor a beloved horse with a goodbye
Recognize a student's big accomplishment

Welcome a new horse to the family

Promote a horse for sale

Special Rates for Personal Promo Ads:

1/4 page: \$50

1/2 page: \$ 75

Full page: \$100

e-mail OFFICE@SOCALDRESSAGE.COM
for more information!

Silent Auction

Once again, our silent auction will be a great opportunity to bid on many fantastic items!!

Don't miss it!

If you would like to support DASC and donate products or services to the silent auction please contact us at: office@socaldressage.com

Thank you for your support!

Official Show Photographer

Rebecca Neff Photography

Rebecca Neff Photography
P.O. Box 6158
Westlake Village, California
91359

reblneff@gmail.com



www.rebeccanefphotography.com



Dressage Equitation Championship



This class will be held at the end of the day on Saturday & will be divided into **Junior and Adult Amateur** divisions.

Class Fee: \$25

Championship Award and medal to first place, and medals to 6th

Qualification is *easy* !!

Unlike regular championship classes, the Dressage Equitation class only requires **ONE score of 58%** or higher in a Dressage Equitation class. This can be earned at any DASC recognized show **OR *at* the Championship show on Friday!!**

Additionally, **anyone who is qualified for any DASC Championship class**, is also qualified to participate in the DASC Dressage Equitation Championship.

If you would like to do this (and c'mon, you know it will be fun!), be sure to sign up for both the qualifier and the championship class on your entry.

For more information on Dressage Equitation Classes – go to the DASC website: www.socaldressage.com

Silent Auction

Once again, our silent auction will be a great opportunity to bid on many fantastic items!!

Don't miss it!

If you would like to support DASC and donate products or services to the silent auction please contact us at: office@socaldressage.com

Thank you for your support!

VOLUNTEERS!!

We need YOU!!

The success of the Championship show really depends on the help of volunteers like you. Whether you can give a couple of hours or the whole weekend, please share your energy with us and be part of a great event!

All volunteers get great gift bags, free food and drink, raffle prizes and our never-ending and deepest gratitude!!

To sign up to **VOLUNTEER**, go to our Volunteer sign up page at:

<http://vols.pt/Fytas2>

we need scribes, ring stewards, hospitality help, office help, set up, tear down, and test pickups

NO experience necessary for most jobs!

Enter the Championship Show

ONLINE

If you have used this service for other shows,
you know how great it is!

Build your profile & simplify the process for many shows all year.

Online entry also makes it possible to use credit cards to pay for your show fees! (You can use the regular entry form to pay by check)

www.equestrianentries.com

**UNITED STATES EQUESTRIAN FEDERATION**

The national governing body for equestrian sport

**Equestrian**

The official magazine of the USEF



Changing the way you look at equestrian sport



shopUSEF.com

A fresh approach to classic equestrian style.



The United States Equestrian Federation was founded in the spirit of fair play and the safety and well-being of both human and equine athletes in competition. Join 84,000 members who love horses & equestrian sport. Visit usef.org for more information.

USEF Membership Benefits: USEF is dedicated to education, the recognition of achievement, and promotion of dressage. For details on member benefits, including educational programs, awards, and other opportunities, refer to the USEF Member Guide or the USEF website at www.usef.org.

Membership Requirements for USEF-licensed/USEF-recognized Competitions: Owners and riders, including foreign riders and owners who are not residents of the US, wishing to participate in a USEF-licensed/USEF-recognized competition as a rider or owner/lessee, must have either a USEF Group Membership, Participating Membership (PM), or have a USEF Non-Member (NM) identification number and pay the USEF NM fee. (Note: USEF business members can own horses but cannot compete as riders with their USEF BM.) Individuals cannot compete at a USEF-licensed/USEF-recognized competition with a USEF Education Membership.

Horses competing at USEF-licensed/USEF-recognized competitions must have either a USEF Horse Identification (HID) number or a USEF Lifetime Horse Registration (LHR). Proper credentials or verification certificates must be presented to the competition secretary.

Riders and owners wishing to participate in a USEF-licensed/USEF-recognized competition, and not able to present the competition secretary with verification of a USEF membership or NM identification, and USEF LHR or USEF HID, must complete a USEF Competition Affidavit Form and pay the \$5 affidavit filing fee. A copy of a completed affidavit form from another competition may also be used for verification purposes for up to 60 days. (Exception: Affidavits cannot be used at Great American Insurance Group/USEF Regional Dressage Championships.)

Exceptions:

- Horses competing only in Individual Breed Classes (IBCs) at DSHB competitions, sires and dams of horses in DSHB group classes, where those sires or dams are not actually competing in the same competition, horses competing only in breed restricted dressage or DSHB classes at Regular Competitions (e.g. all Arabian, all Friesian, or all Morgan classes), or in USEF Introductory Level tests, pas de deux, quadrille, FEI Para-Equestrian classes, are exempt from this requirement. Also exempt are horses ridden in headline, exhibitions, games and races, classes for 4-H members, walk-trot, academy and opportunity classes.
- Riders and owners/lessees competing only in classes which are exempt from the USEF HID requirements are also exempt from the USEF NM identification number and NM fee requirements. Also exempt are handlers of horses competing in DSHB In-Hand or Group classes.

Memberships Defined

Participating Membership (PM): A membership issued to an individual directly by USEF. The membership year is December 1 through November 30. PMs are available for 1-year (\$75), 5-years (\$300), or life (\$1,500). A USEF Youth Participating Membership (YPM) is available for individuals who have not reached their 21st birthday by December 1 of the current membership year (\$60). A PM allows the member to compete at USEF-licensed/USEF-recognized competitions and to participate as a rider and/or owner/lessee for all Adequan®/USEF Year-End Awards, Great American Insurance Group/USEF Breeders Championship Series Finals and the Great American Insurance Group/USEF Regional Dressage Championship program.

Group Membership (GM): A membership issued to an individual by USEF when the member name and dues are submitted to USEF through an affiliate Group Member Organization (GMO). The GM year begins December 1 and ends November 30. A GM allows the member to compete at USEF-licensed/USEF-recognized competitions and participate in the USEF Rider Awards program.

Business Membership (BM): A membership that runs December 1 through November 30 and is issued to a business or organization directly by USEF. The USEF BM (\$200) offers a wider variety of advertising benefits. BMs satisfy requirements of horse ownership only.

Education Membership (EM): A membership issued to an individual directly by USEF. This online education only membership expires 12 months after the date joined. This membership type does NOT allow an individual to compete at a USEF-licensed/USEF-recognized competition.

Non-Member (NM) Identification Number: For each USEF NM owner/lessee and USEF NM rider there will be a USEF NM fee of \$25 per competition that must be collected by the show secretary and submitted to USEF, along with the USEF Report of Fees document and the \$5 affidavit fee and Competition Affidavit Form if the person cannot provide a copy of their USEF NM card. Owners/lessees or riders exempt from the NM number requirements are also exempt from paying the USEF NM fee. If there are multiple owners of a horse and all are NMs, only one of the owners must pay the NM fee. If the horse has at least one owner who is a current USEF PM, GM, or BM there is no NM fee assessed. Competition management will be invoiced for all applicable USEF NM fees not received with the USEF post competition paperwork, along with a report listing all USEF NMs. Competition management is then required to submit the NM fees within 30 days to the USEF. An individual with a USEF NM identification number is not eligible for any USEF membership benefits. Once a USEF NM number has been assigned, a USEF NM card can be obtained from the USEF website.

Horse Identification (HID) Number: A one-time tracking number for horses (\$25). Scores earned by a horse with an HID number will be recorded, but will NOT be counted towards Adequan®/USEF Year-End Awards. A horse with an HID number is not eligible to compete in Great American Insurance Group/USEF Regional qualifying or championship classes or Great American Insurance Group/USEF Breeders Championship Series Finals. An HID number can be upgraded to a Lifetime Horse Registration (LHR) for a fee of \$70. If a horse has a USEF LHR it does not need an HID number. An HID number is a one-time fee that does not need to be renewed.

Lifetime Horse Registration (LHR): A horse with an LHR (\$95) is eligible for Adequan®/USEF Year-End Awards, and eligible to compete at Great American Insurance Group/USEF Breeders Championship Series Finals and Great American Insurance Group/USEF Regional qualifying and championship classes, assuming requirements for the owner and rider are met. If a horse has an LHR it does not need an HID number. An LHR does not need to be renewed.

How to Join USEF

Applications for USEF Participating Membership (PM), Business Membership (BM), Horse Identification (HID) number, and Lifetime Horse Registration (LHR) may be found in the following locations:

- On the USEF website: www.usef.org. You can submit the application online or download the form and fax or mail it to the USEF office.
- In the show office at USEF-licensed/USEF-recognized competitions classified by USEF as Dressage Competitions, and Regular Competitions which are open to all breeds.
- By calling or writing the USEF office at (859) 971-2277, 4051 Iron Works Parkway, Lexington, KY 40511

The effective date of membership is the date the form and correct fees are received in the USEF office or, if applying at a competition, the date accepted by the competition secretary, provided the application is signed and dated by the competition secretary, member, and/or horse owner on that same day.

07/14

USEF Statement on Animal Welfare

The United States Dressage Federation, Inc. (USEF), a federation of 125 independent organizations throughout the United States with a membership in excess of 30,000 members, supports the concept of ethical treatment of animals.

Dressage is a classical method of training horses, based upon the horse's natural responses, as carried out in a gradual, planned program during which the horse's athletic abilities are improved in a systematic manner. As a result, the horse becomes capable, comfortable, and responsive in partnership with the rider without the use of force. Dressage competition at various levels of achievement is the ultimate test of the training program to determine whether the desired harmony between horse and rider has been achieved.

The rules pertaining to dressage competition prohibit the use of artificial appliances, training aids, and drugs, which would force the horse to submit. Instead, the emphasis is upon training and a cooperative partnership with the rider. Major competitions are carefully monitored to assure that there is no unnecessary force or harshness displayed.

Unlike other horse sports in which horses enter training at a relatively immature state, dressage training is usually not seriously begun until the horse is three or four. The top levels of achievement require five or more years of progressive training and it is not unusual to see horses in international competition in their late teens. This, in itself, places a premium on good care and soundness throughout the horse's life.

While supporting the concept of animal welfare in its broadest form, the United States Dressage Federation, Inc., also recognizes that it is unrealistic to ascribe human emotions and responses to the horse which in its wild state is a creature of flight, living a hard and precarious existence. Under domestication, the horse is assured of ample food, water, and shelter, as well as protection against infectious diseases and damaging parasites, thus leading a longer and healthier life with a high rate of survival.

As an educational organization, USEF has numerous programs, which teach people how to pursue the accepted, humane training methods. A program of certifying instructors also emphasizes protecting the horse's welfare in pursuit of dressage training.

United States Dressage Federation

4051 Iron Works Parkway, Lexington, KY 40511

Phone: 859-971-2277, Fax: 859-971-7722, udressage@usef.org, www.usef.org**ATTENTION COMPETITORS**

Each competitor is responsible for supplying management with correct applicable numbers (USDF and USEF) for horse, owner, rider, and trainer, before the day(s) of the competition.

The scores of competitors who fail to supply correct numbers may not be counted toward national awards.



UNITED STATES Dressage FEDERATION

USDF/Dover Saddlery Adult Amateur Medal Program Invitation

USDF/Dover Saddlery Adult Amateur Medal Program**Dear Competition Contact:**

This is your official invitation to host the USDF/Dover Saddlery Adult Amateur Medal Program at your competition(s). This class is designed for Second Level adult amateurs and is growing in popularity and visibility. Previously, over 600 USDF competitions offered the USDF/Dover Saddlery Adult Amateur Medal Program.

The benefits to your competition include:

- No cost to your competition to participate.
- You do not have to add a class. Simply designate an existing Second Level Test Three class or applicable test of choice class. If the rider enters the test of choice class they must ride Second Level Test Three.
- The USDF/Dover Saddlery Medal class is being sought out by many adult amateurs.
- Limited paperwork: simply return the Official Record of Winner Form with your post competition paperwork to USDF.
- For every competition offering the USDF/Dover Saddlery Medal Program, the competition's secretary will be entered into a drawing to win a \$200 Dover Saddlery shopping spree. The drawing will take place mid October.

What is required of competition management to participate in the USDF/Dover Saddlery Medal Program?

- Check the Dover box on the USEF/USDF Joint Application for License Agreement or e-mail dovermedal@usef.org.
- Designate and list the Second Level Test Three class or applicable test of choice class the USDF/Dover Saddlery Medal class in your prize list.
- Award the USDF/Dover Saddlery Medal packet according to the published requirements to the winner at the competition.
- Return your Official Record of Winner Form to USDF with your post competition paperwork.

There are great prizes for the Second Level Adult Amateur:

- A \$20 Dover Saddlery gift certificate for each USDF/Dover Saddlery Medal won (up to three).
- The USDF/Dover Saddlery National Merit Award (for winning three USDF/Dover Saddlery Medals).
- Year-end awards: The USDF/Dover Saddlery Medal National Champion and Reserve Champion are determined by the average of the top three winning ride scores during the competition year. The champion receives a \$1000 Dover Saddlery gift certificate and the reserve champion receives a \$500 Dover Saddlery gift certificate.

To participate, check the Dover box on the USEF/USDF Joint Application for License Agreement or e-mail dovermedal@usef.org. You will then receive a packet containing the prepackaged USDF/Dover Saddlery medal and neck ribbon to be presented at your competition and a competition contact information card. Public announcements and an opportunity to earn free Dover Saddlery gift certificates for your competition can be accessed by visiting www.DoverSaddlery.com/DoverMedal.

For your convenience, a prize list insert may be found on the USEF website under the performance awards page.

Please contact me if you have any further questions. Thank you for your ongoing support of the adult amateur competitor.

Sincerely,

Cristen Brown

Cristen Brown
Awards Services Coordinator
Dovermedal@usef.org
859-971-7361

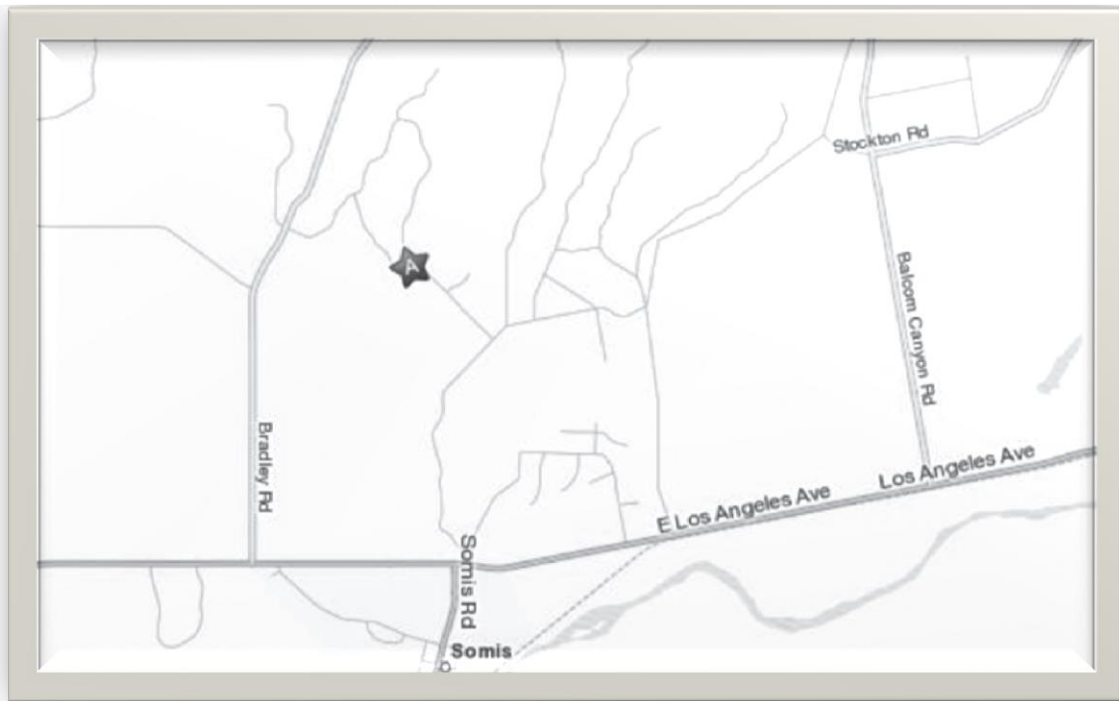

Directions to El Sueno Equestrian Center

5250 East Kingsgrove Road, Somis, CA 93066 (805) 386-2600

From the 118 or 23: Take the Los Angeles Avenue exit. Head west through Moorpark. Continue west about 7 miles, Turn right onto Donlon Road. Turn left on to Kingsgrove, app 1/2 mile facility is on the left hand side. Follow road to the end.

From the 101 North: Take Lewis exit in Camarillo. Head east on Lewis until it ends at the 118. Turn right, then immediate left onto Donlon Rd. Left onto Kingsgrove app 1/2 mile. Facility on left hand side. Follow road to end.

From the 101 South: Take the 23 Hwy North towards Fillmore. Exit at Los Angeles Avenue. Head west through Moorpark, turn right on Donlon. Turn left on to Kingsgrove, app 1/2 mile facility is on the left hand side. Follow road to the end.

Area Hotels/Motels

Courtyard by Marriott: 4994 Verdugo Way, Camarillo, 800 321-2211

Hampton Inn & Suites: 50 Daily Dr., Camarillo, 805 389-9898

Best Western Camarillo Inn: 295 Daily Dr., Camarillo, 805 987-4991

Days Inn: 165 E. Daily Dr., Camarillo, 805 388-3467

Motel 6: 1641 E. Daily Dr., Camarillo, 805 388-3467

Holiday Inn Express: 4444 Central Ave., Camarillo, 805 485-3999

Camarillo Country Inn: 1405 Del Norte Rd., Camarillo, 805 983-7171